

For reference only. See data sheet for the detailed specifications.

## Technical Specification



Frequency Range(GHz)	0.7 – 10.0
Gain	Linear: 9dBi Typ.
	Circular: 9dBic Typ.
Polarization	H,V, LHCP & RHCP Switchable
Axial Ratio(dB)	4.0 Typ.
	10.0 Max.
VSWR	2.5:1 Typ.
Connector	SMA-Female
Power Handling(W CW)	20 Max.(Cold Switching)
Power Supply	12V DC
Control	TTL
Control Connector	Circular 10-Pin
Material	Al
Finish	Chemical Conversion Coating and Nickel Plated
Size(mm)	310 x 310 x 537
Net Weight(Kg)	5.85 Around

PATENT ID (US)

US 11139578

PATENT ID (China)

ZL201822143669.2

## Outline Drawing (Size: mm)

SMA Female Output (P/N: LB-OSJ-07100-P04)

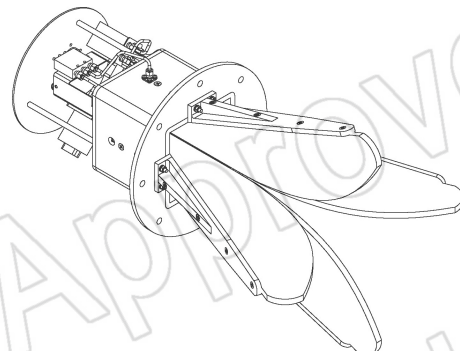
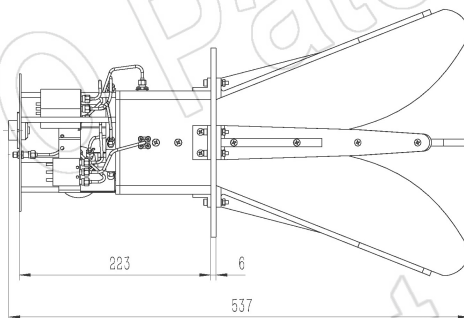
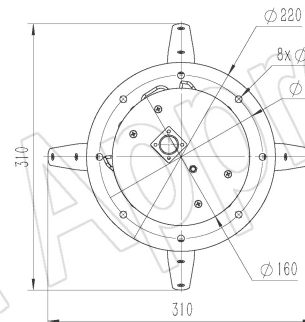
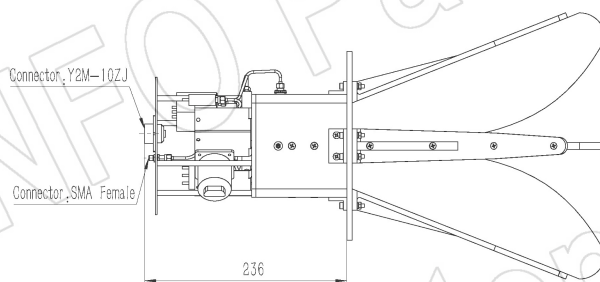

**AINFO Inc.**

China(Beijing):  
China(Chengdu):  
USA :

Tel: (+86) 10-6266-7326,  
Tel: (+86) 28-8519-2786,  
Tel: (+1) 949-639-9688,

(+86) 10-6266-7327  
(+86) 28-8519-3044  
(+1) 949-639-9608

Fax: (+86) 10-6266-7379  
Fax: (+86) 28-8519-3068  
Fax: (+1) 949-639-9670

Website: [www.ainfoinc.com](http://www.ainfoinc.com)  
Email: [sales@ainfoinc.com](mailto:sales@ainfoinc.com)

## SMA Female Output with L Type Mounting Bracket (Option, P/N: LB-OSJ-0760-L)

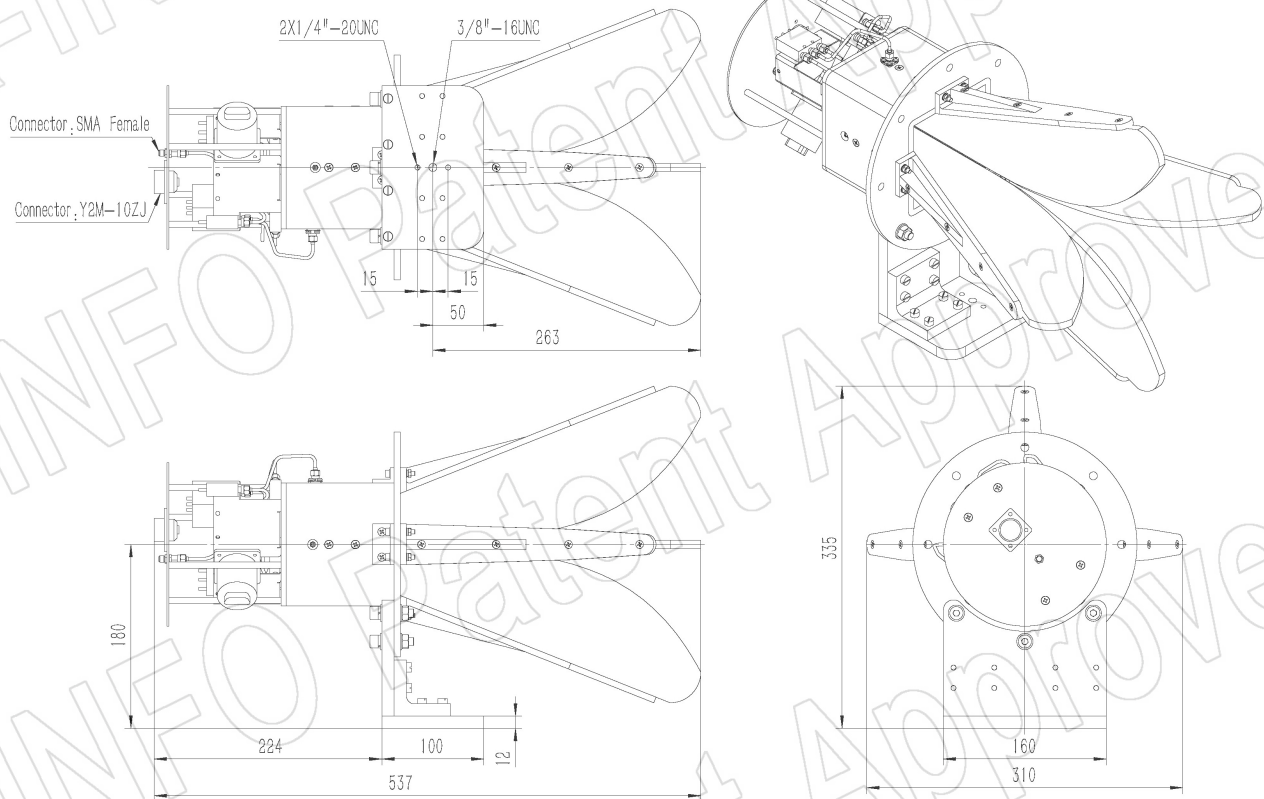

## Standard Configuration

1. Antenna
2. Control Cable, 5m, with Circular 10-Pin connector on each side.

## Optional Accessories

1. Nonmetallic L type mounting bracket, for A-INFO tripod
2. Aluminum Tripod, 15Kg
3. Wooden Tripod, 15Kg

## Control Description

### 1. Pin Description

Pin Number	Name	Description
1	NC	
2	+12V	+12V DC Supply input
3	GND	Ground
4	H	Polarization control :Horizontal
5	V	Polarization control :Vertical
6	C/L	Polarization control :Circular or Linear
7	R	Polarization control :RHCP
8	L	Polarization control :LHCP
9	NC	
10	NC	

### 2. Function Table

Pin \ Pol.	4	5	6	7	8
V	1*	0	0	0	0
H	0	1*	0	0	0
RHCP	0	0	1*	1	0
LHCP	0	0	1*	0	1

\* TTL level should be keep at “1” (high level)

## Test Results

### 1. Gain

Linear Gain

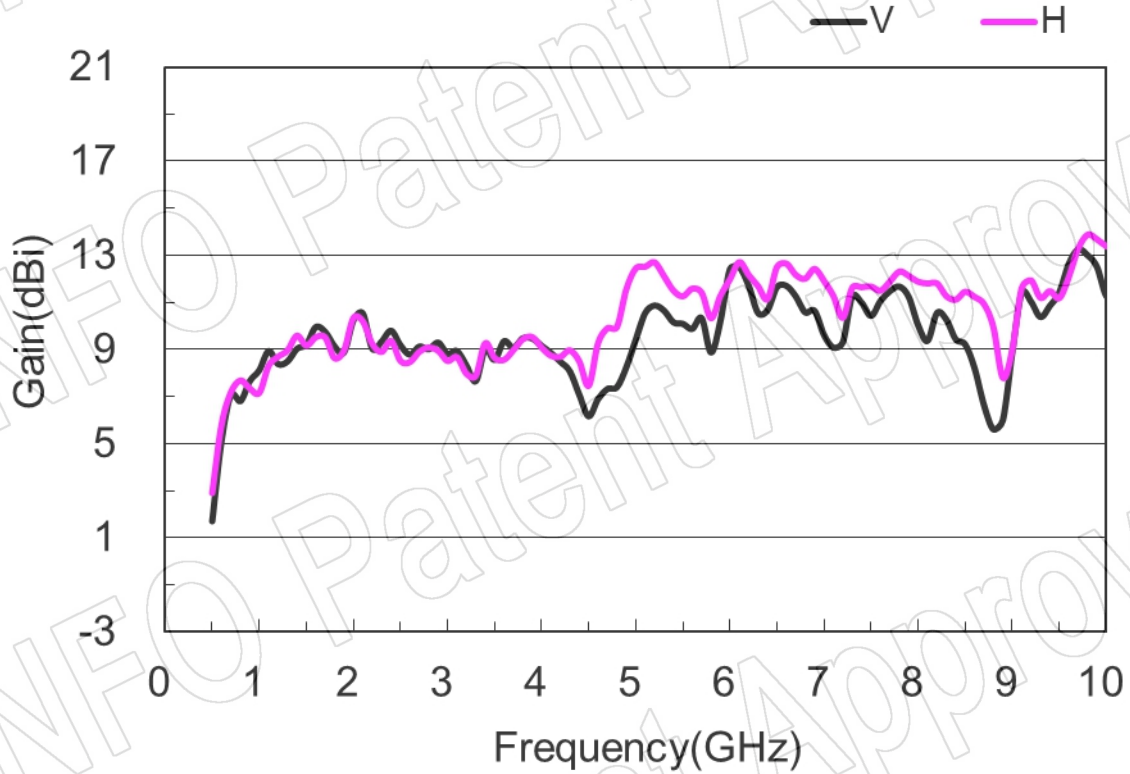

Circular Gain

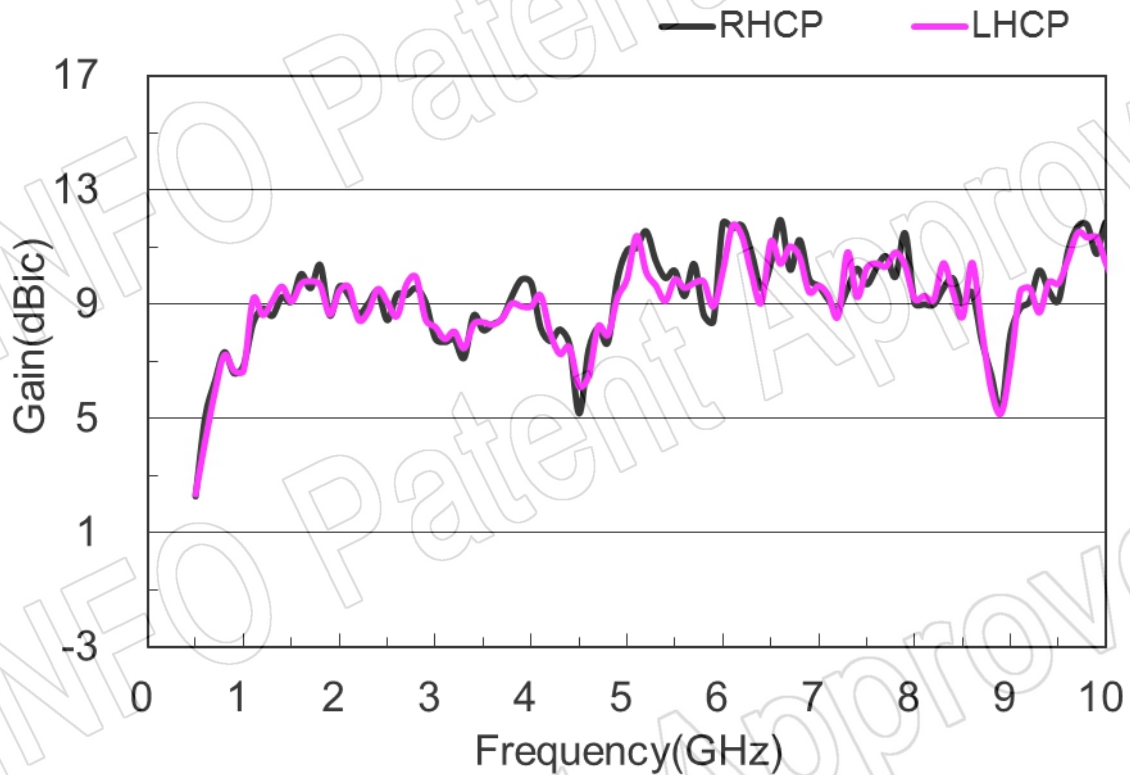

## 2. Axial Ratio

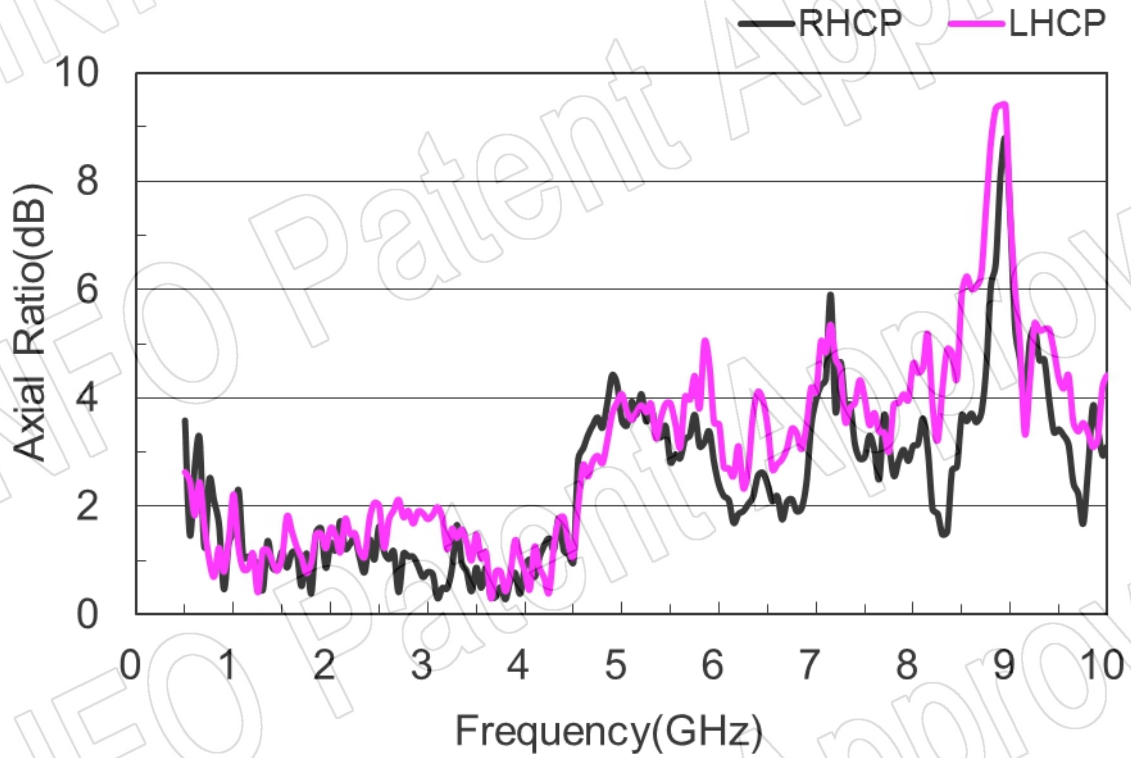

### 3. VSWR H Polarization

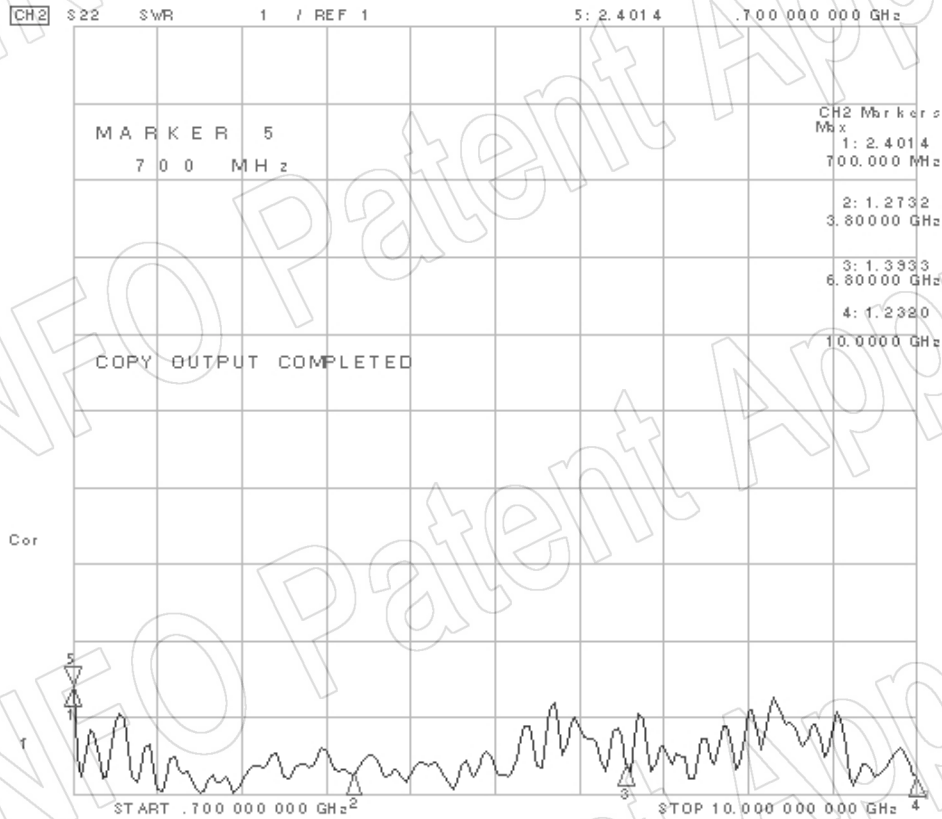

### V Polarization

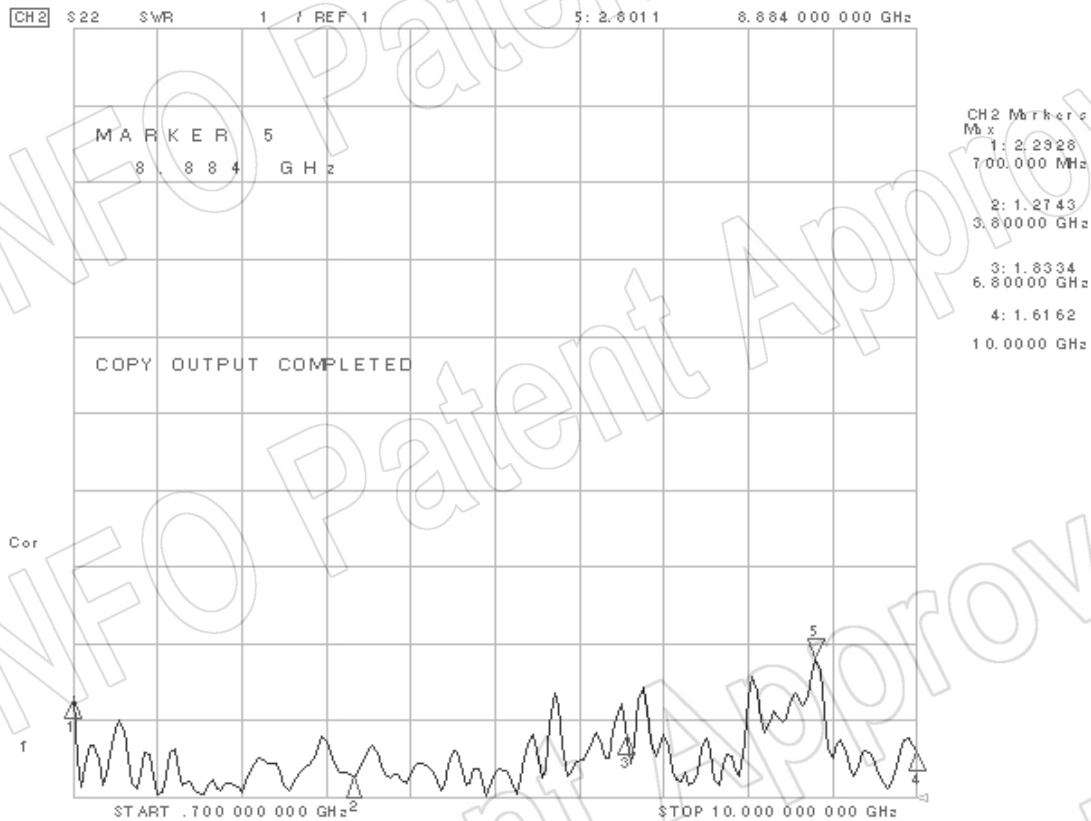

## LHCP

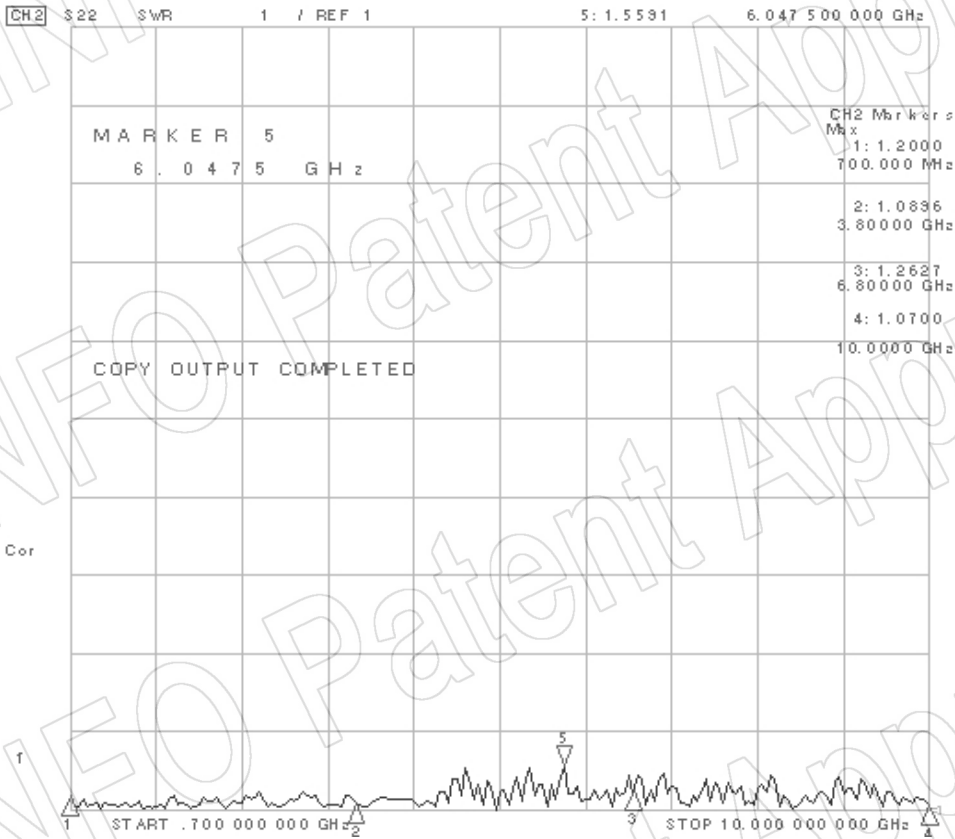

## RHCP

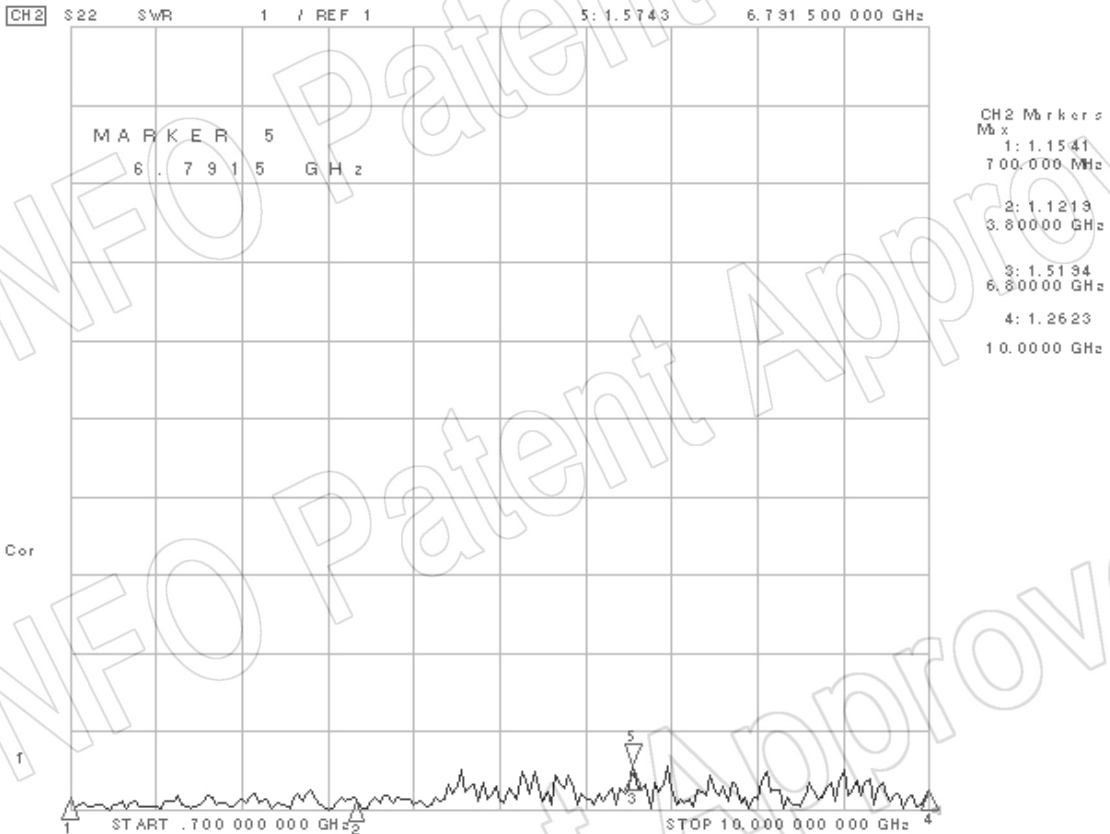

## 4. Pattern Linear Polarization

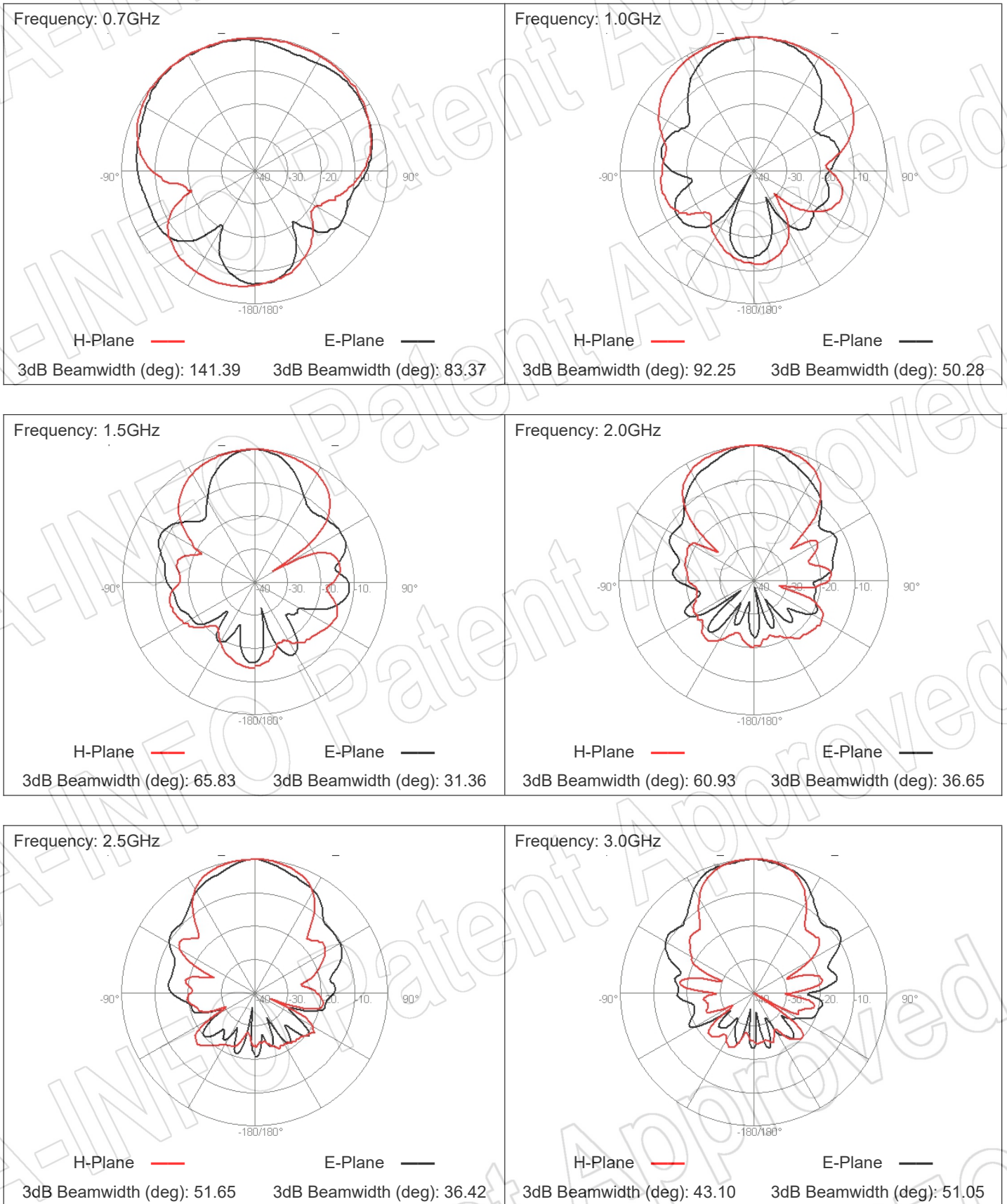



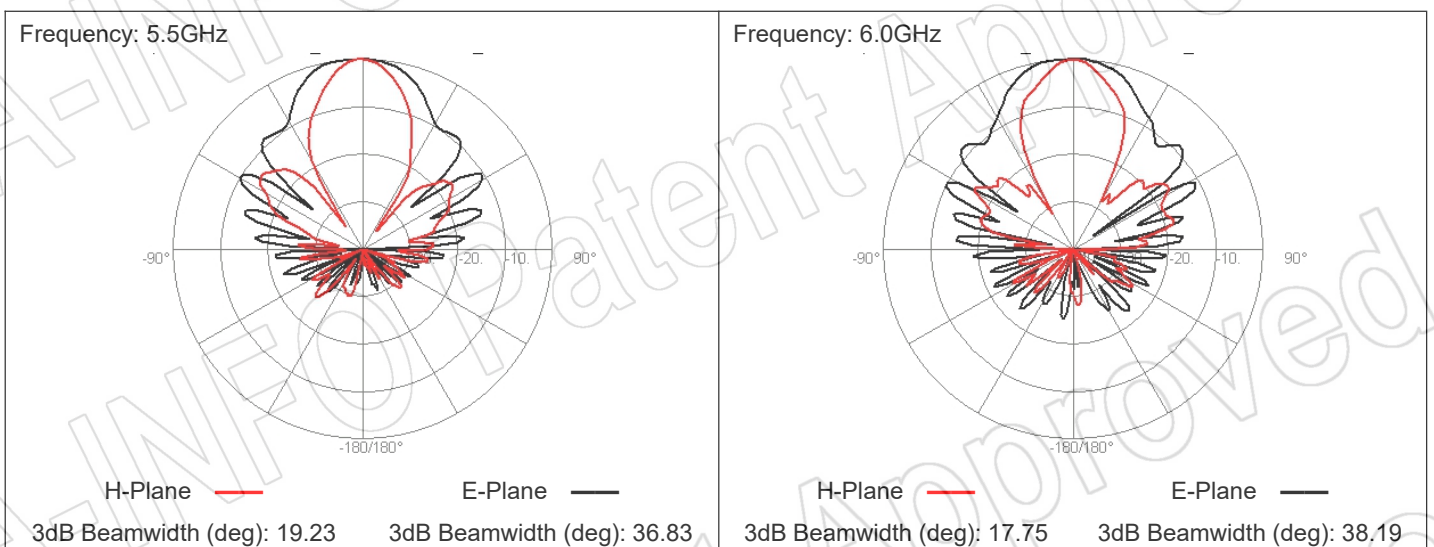
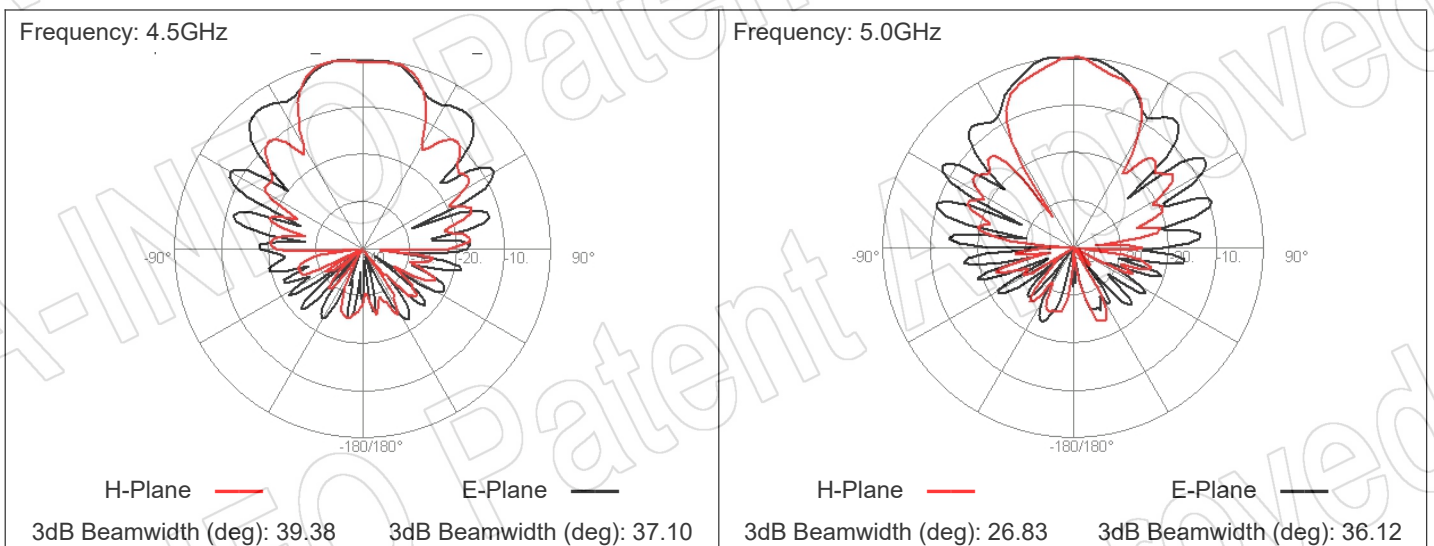
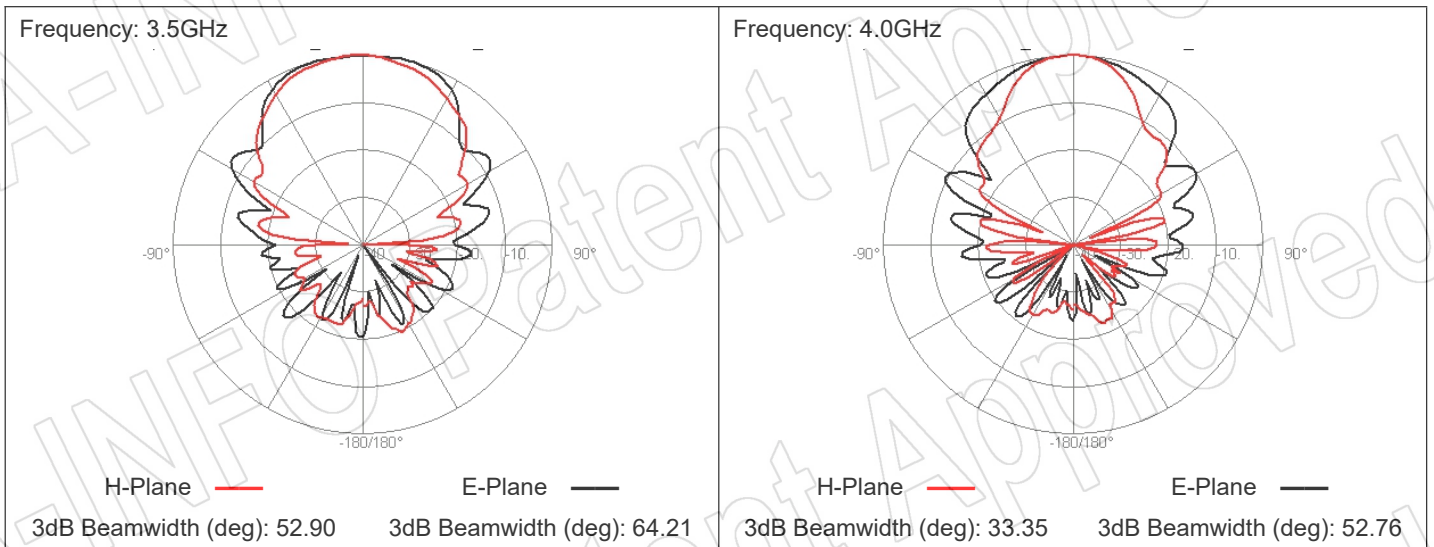

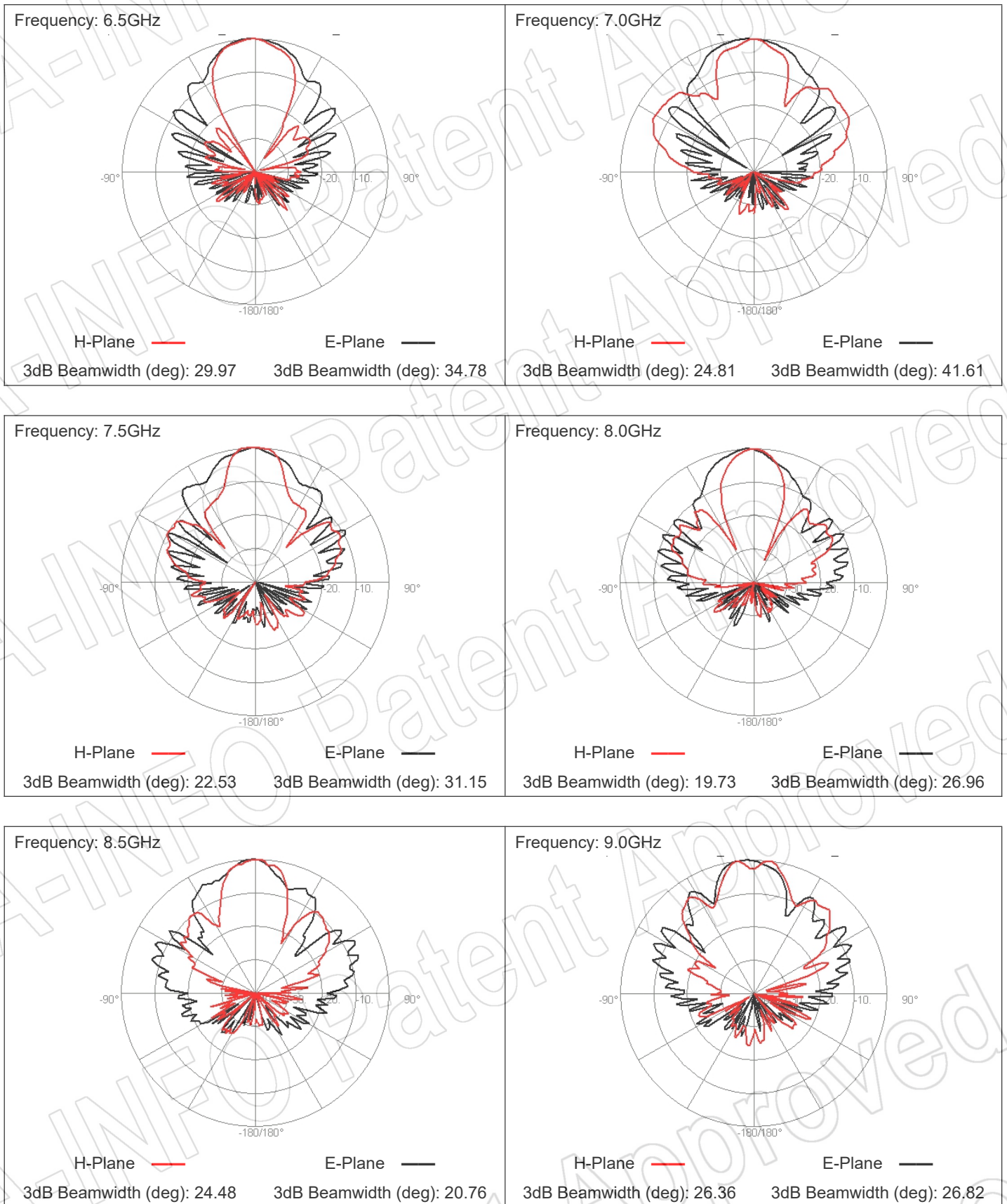

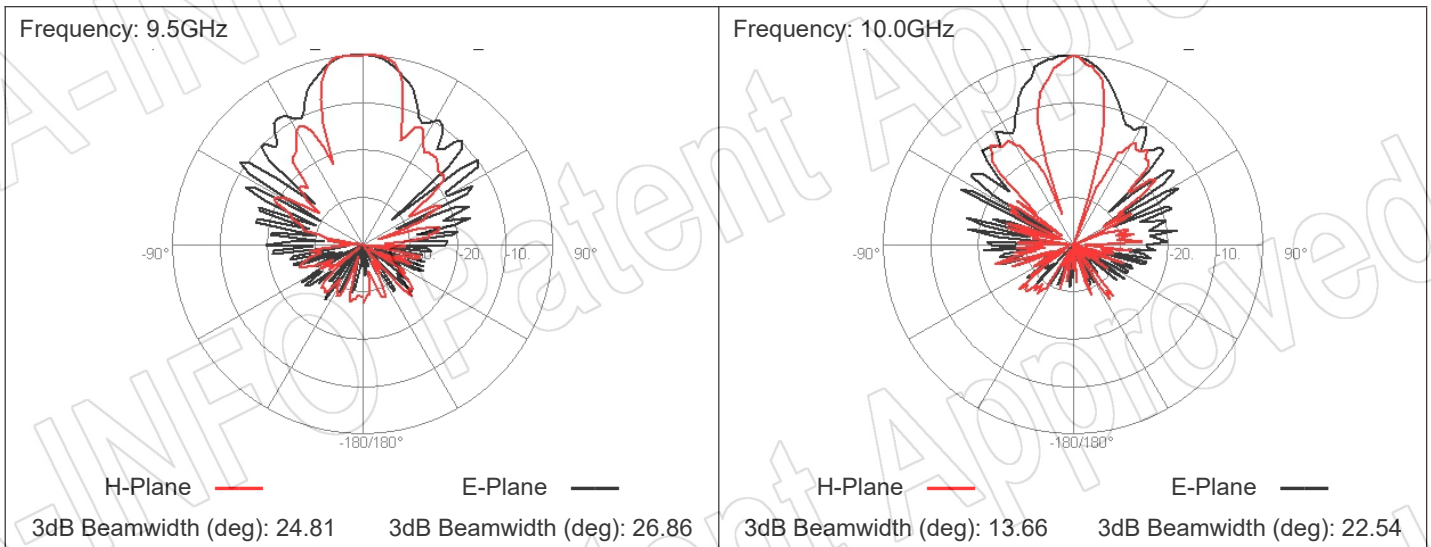

**LHCP**

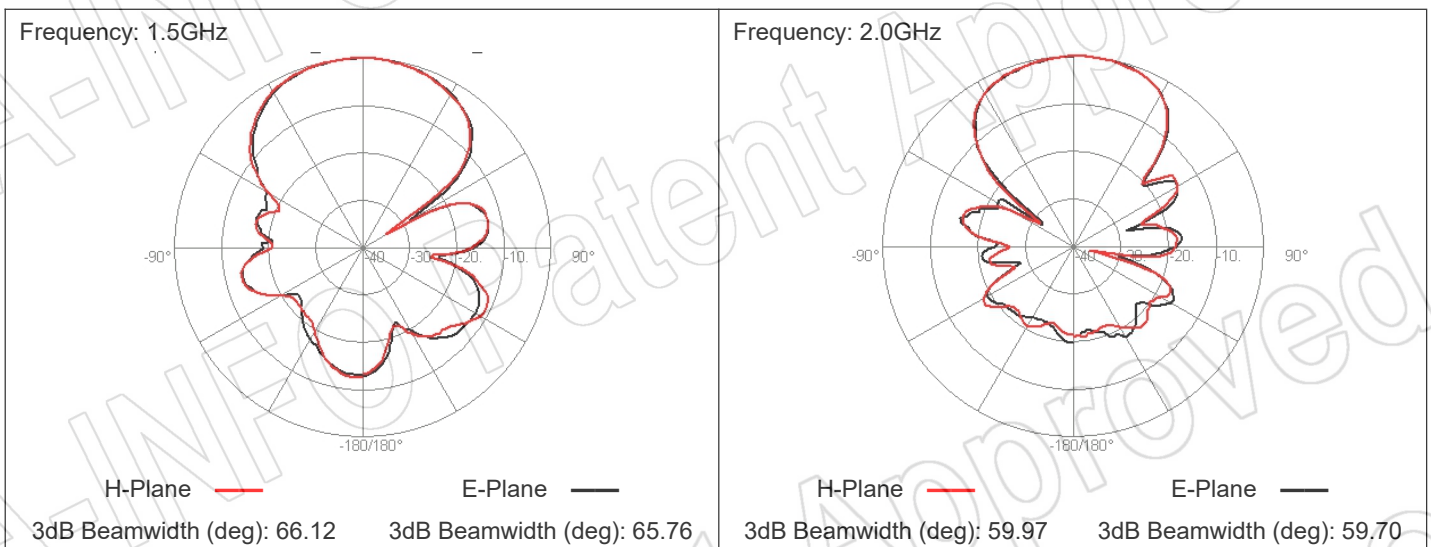
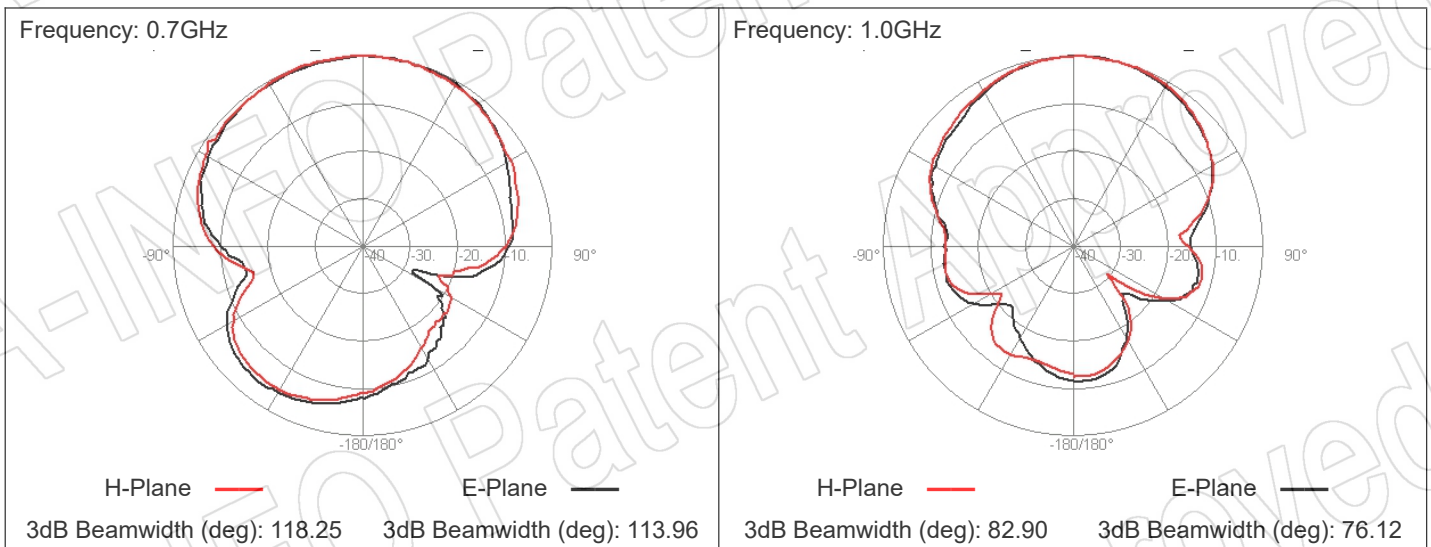

LHCP

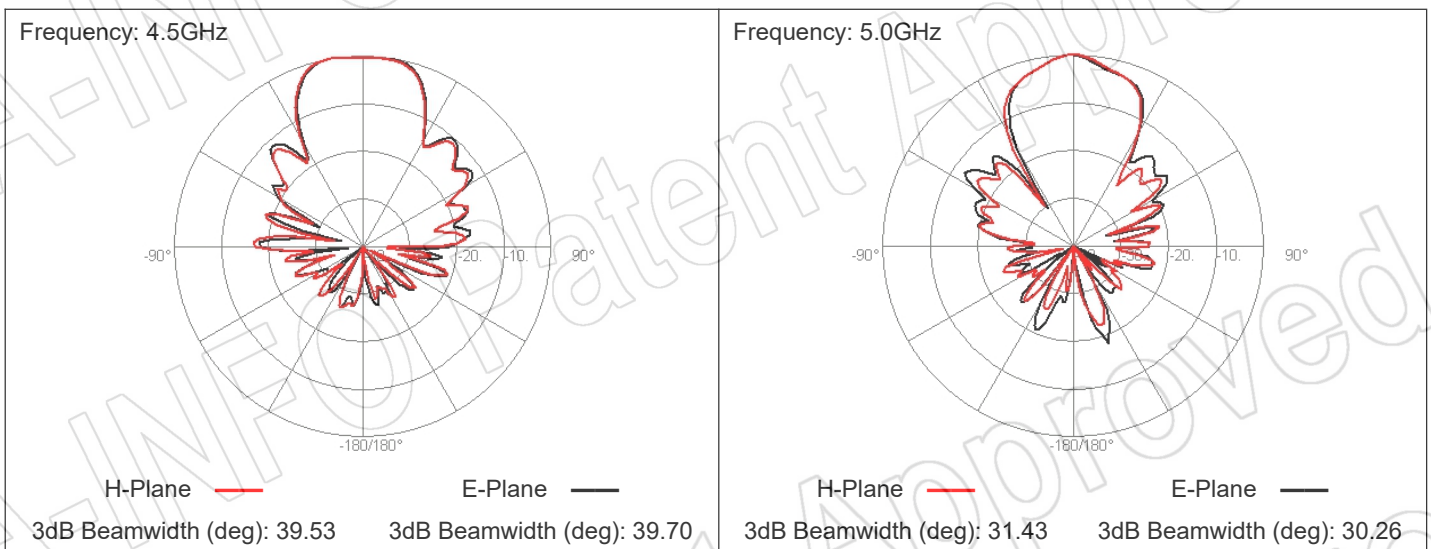
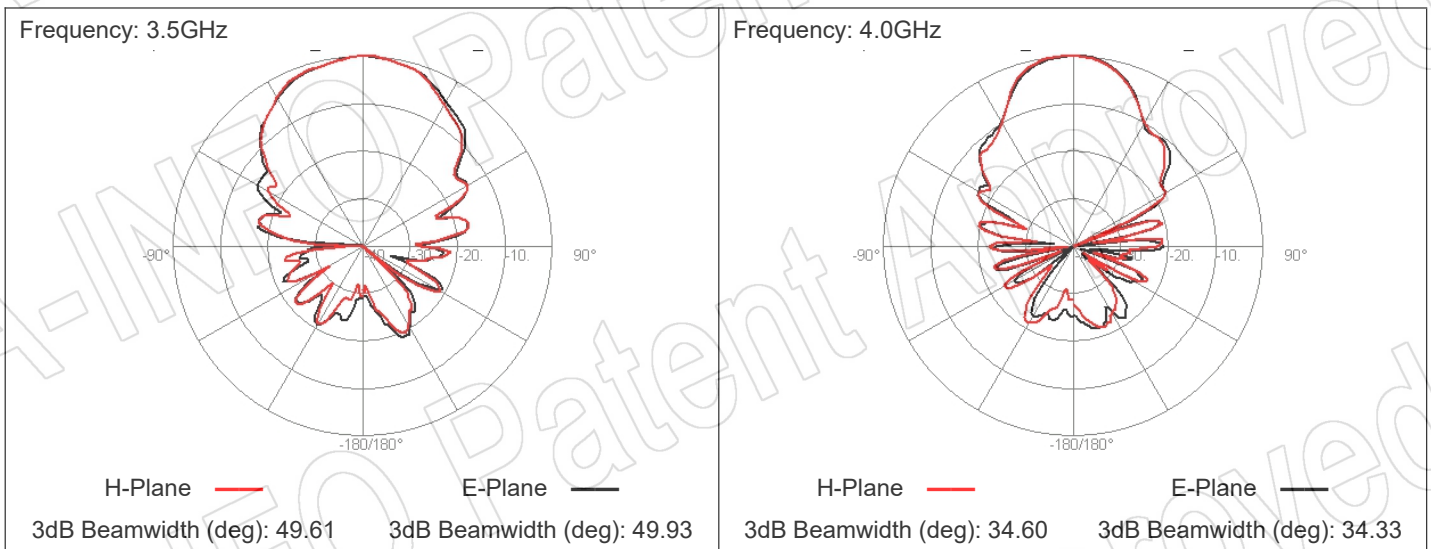
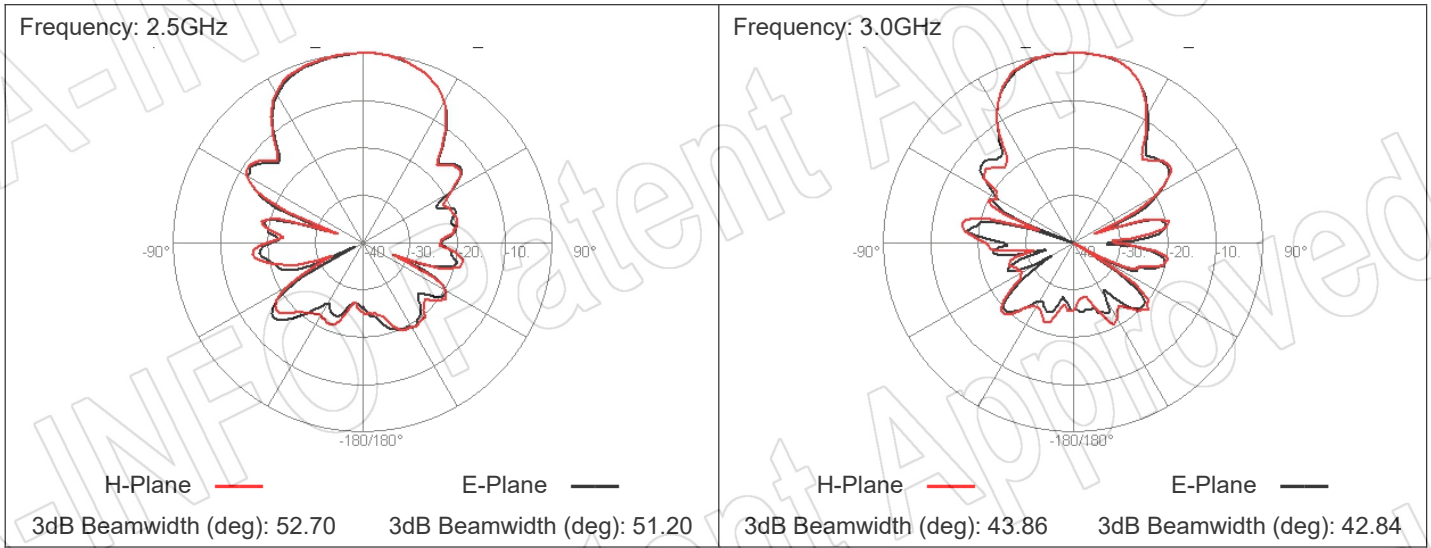

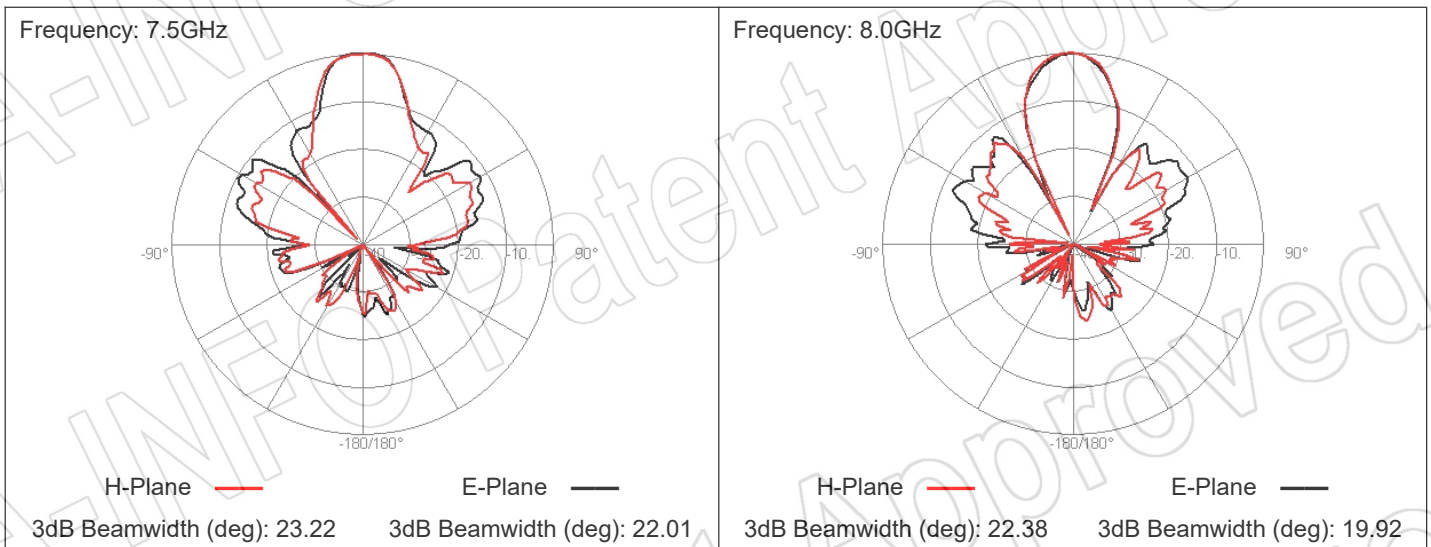
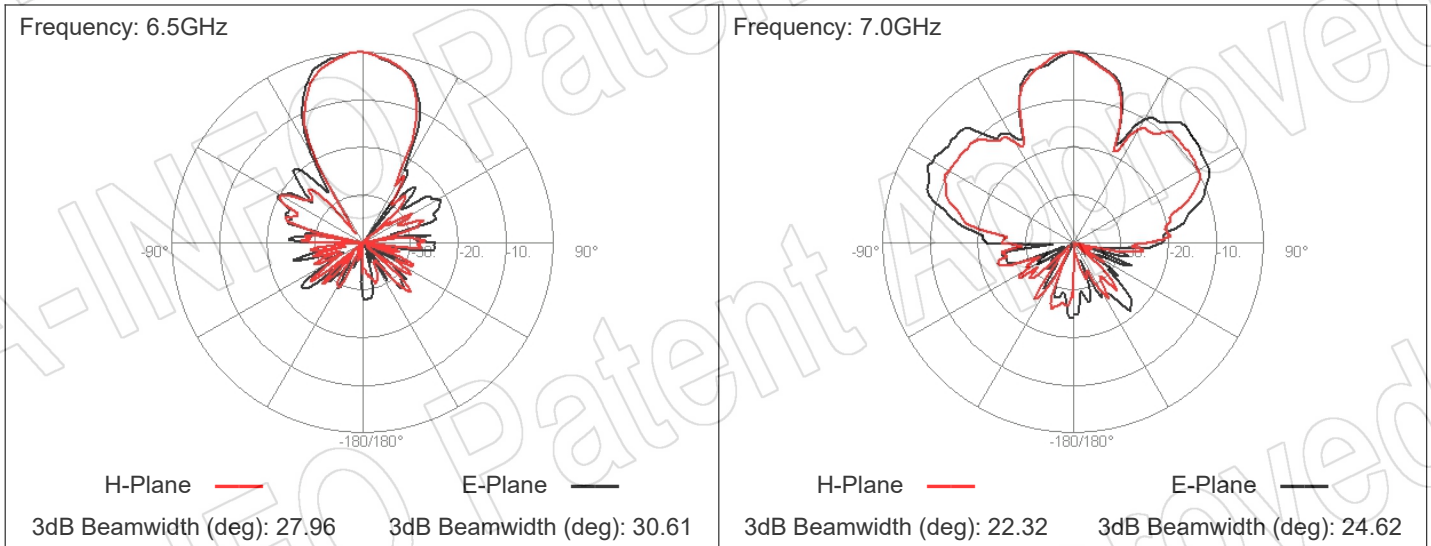
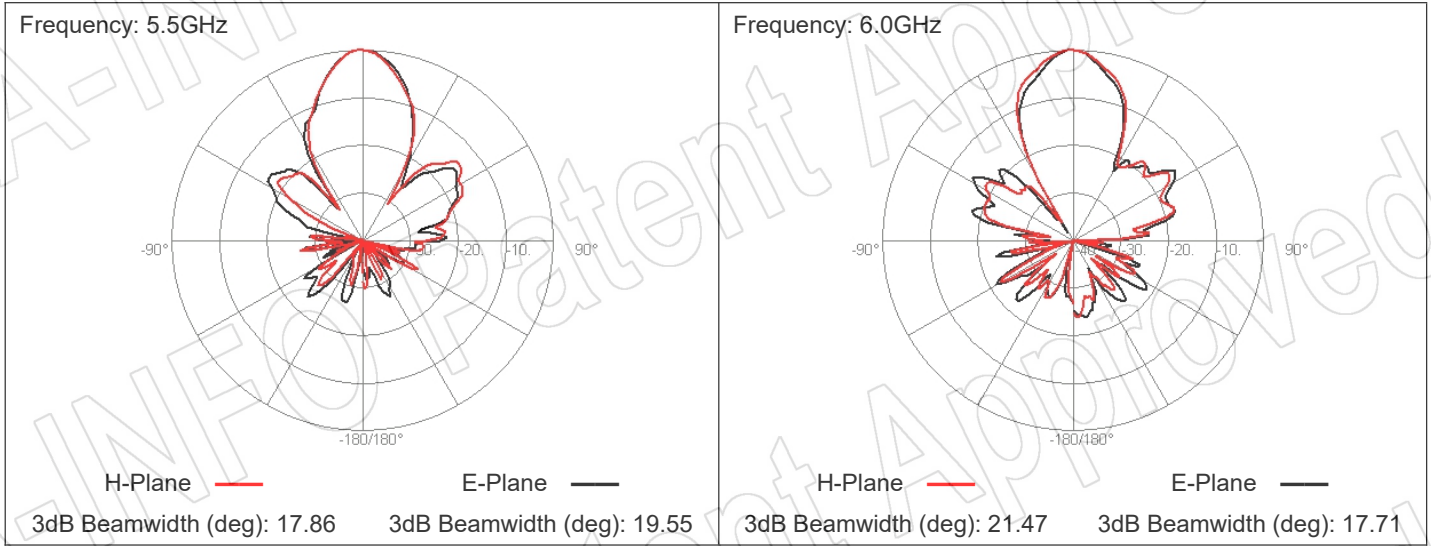

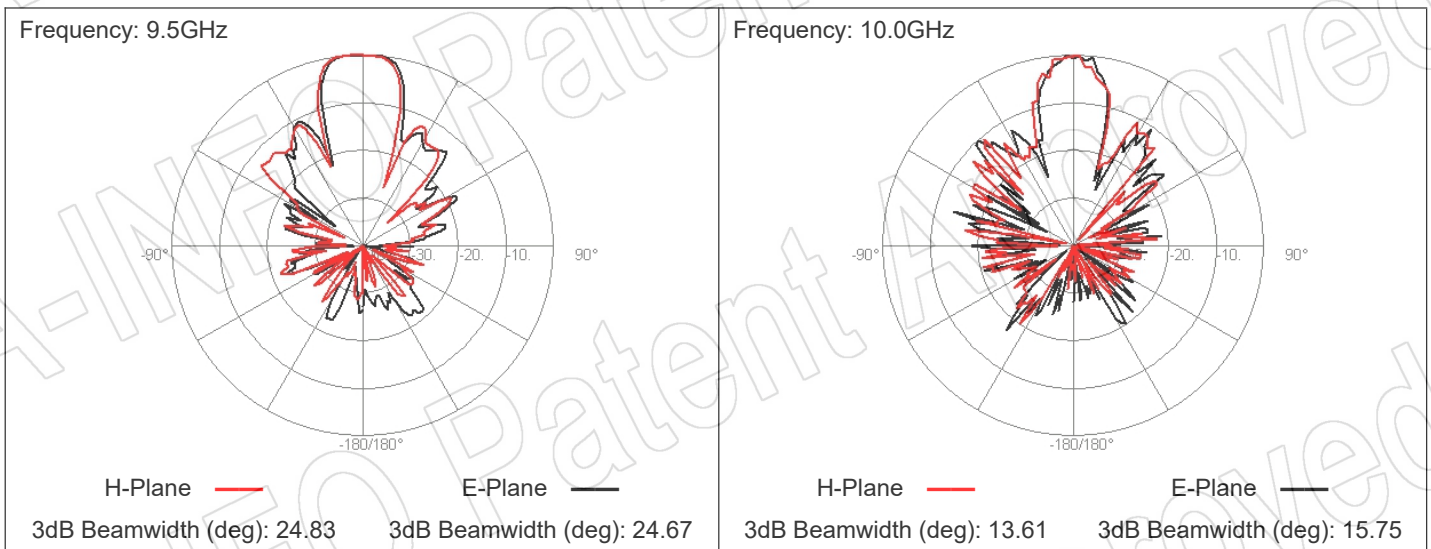
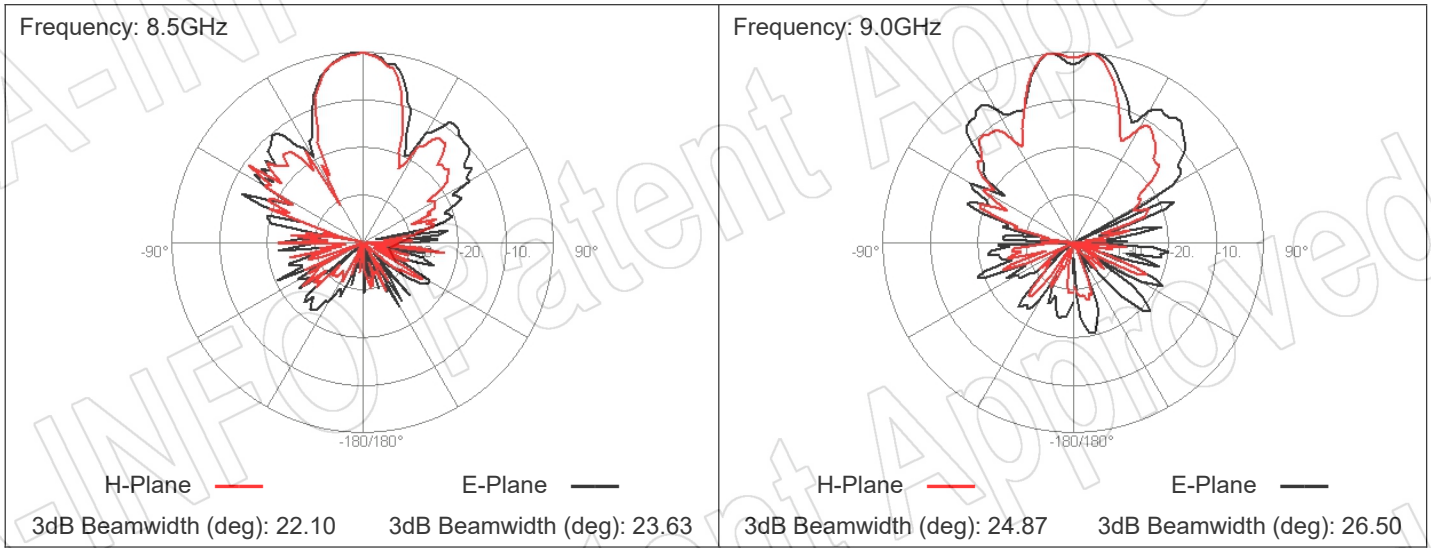

## RHCP

